

A GRIFFITHS ROAD

B MONTAGUE ROAD

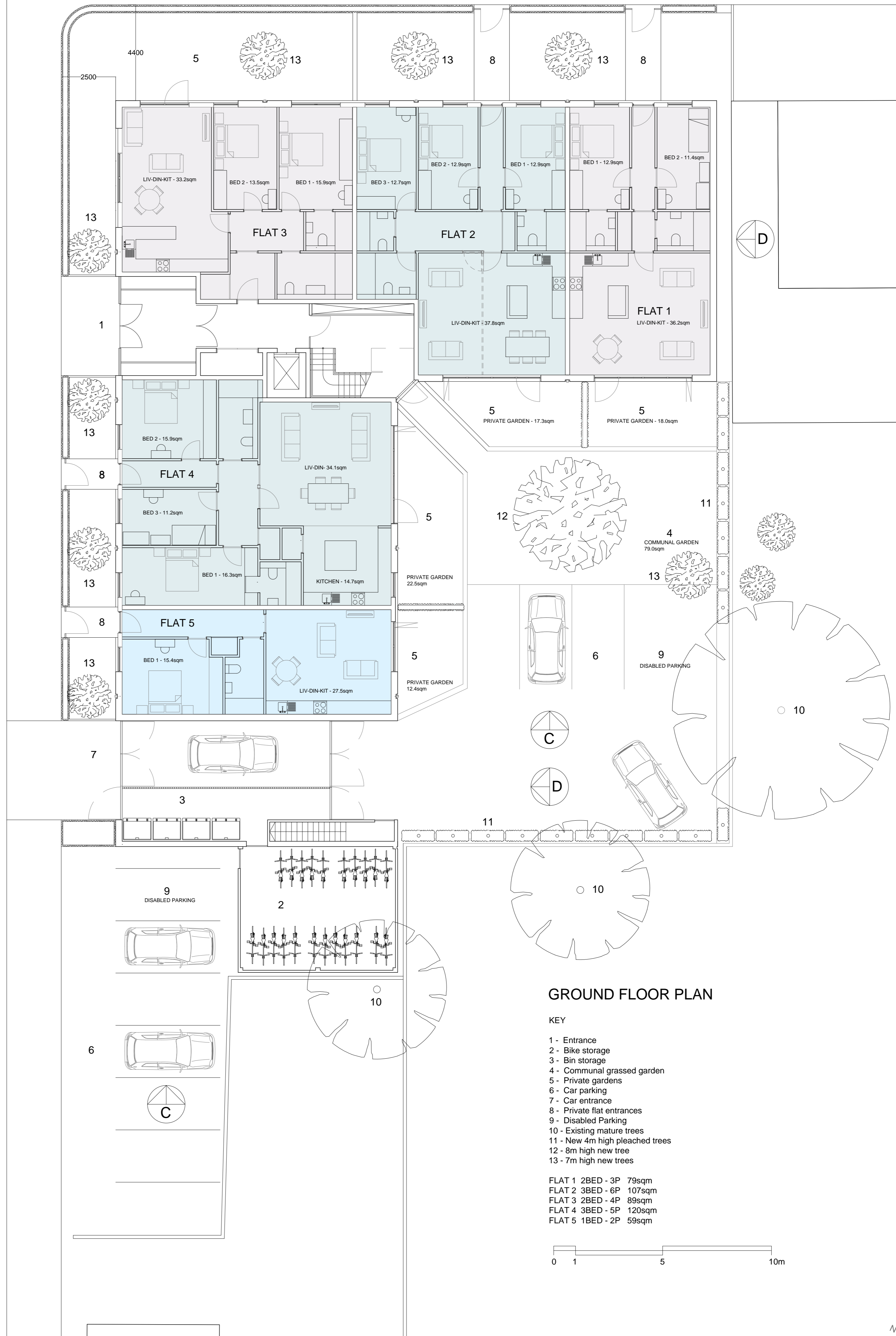

GROUND FLOOR PLAN

KEY

- 1 - Entrance
- 2 - Bike storage
- 3 - Bin storage
- 4 - Communal grassed garden
- 5 - Private gardens
- 6 - Car parking
- 7 - Car entrance
- 8 - Private flat entrances
- 9 - Disabled Parking
- 10 - Existing mature trees
- 11 - New 4m high pleached trees
- 12 - 8m high new tree
- 13 - 7m high new trees

- FLAT 1 2BED - 3P 79sqm
- FLAT 2 3BED - 6P 107sqm
- FLAT 3 2BED - 4P 89sqm
- FLAT 4 3BED - 5P 120sqm
- FLAT 5 1BED - 2P 59sqm

0 1 5 10m

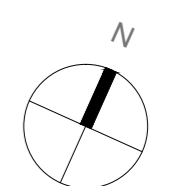

A1

© 3W Architecture Limited. All rights reserved. 3W Architecture Limited registered in England. Company no. 3132871 Registered Office The Pines Boars Head East Sussex	Rev	Date	Amendment	Date	Project	Job Ref.	Job no.	
	A	12.11.2015	Issued for Planning application	May 2015	Griffiths Road SW19	GRW	158	
	B	17.11.2015	Issued for Planning application	Scale @ A1	Checked	Title		
	C	18.12.2015	Habitable rooms and garden sizes added and adjusted - Issued for Planning application	1:100		Ground Floor Plan		
	D	06.01.2016	Landscaping amended to mitigate overlooking - Issued for Planning application	Status	Dwg. no.		Rev.	
E	12.01.2016	Design and Planning Officer comments incorporated - Issued for Planning application	Planning	185(10)005		E		
				Architect	3W Thames Wharf Studios Rainville Road London W6 9HA tel. 020 7835 5552 fax. 020 7835 5525 email. mail@3w.org			

This page is intentionally left blank